

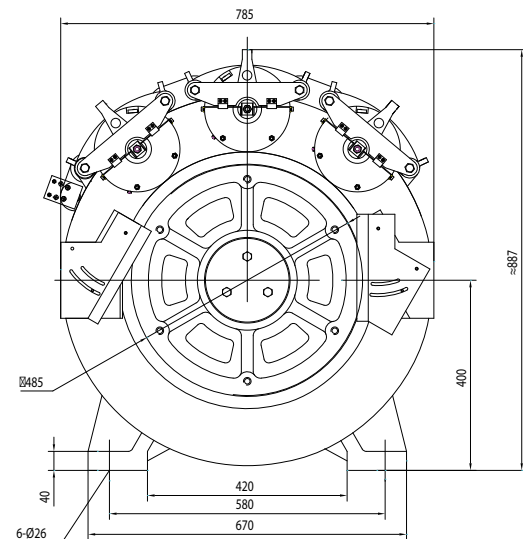

# GTN2

## Elevator Traction Machine

Voltage: 380V  
Suspension: 2:1  
Brake: DC110V 2/3\*0.93A  
Weight: 1150kg  
Max. Static Load: 8000kg

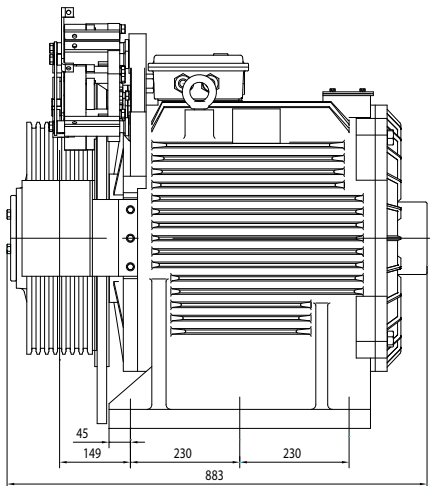

Spec	Load (kg)	Speed (m/s)	Height (m)	Sheave Ø (mm)	Rope sheave (mm)	Current (A)	Torque (Nm)	Rated speed (rpm)	Frequency (Hz)	Power (kW)	Double roping	Outside support	Pole	Rating	INS. class	IP code
GTN2-161P0	1600	1,0	≤ 150	Ø 485	5XØ12X18	26	1320	80	13,3	11	NO	NO	20	S5(40%)	F	IP41
GTN2-161P6	1600	1,6	≤ 150	Ø 485	5XØ12X18	39,5	1320	127	21,2	17,6	NO	NO	20	S5(40%)	F	IP41
GTN2-161P7	1600	1,75	≤ 150	Ø 485	5XØ12X18	44,2	1320	139	23,2	19,2	NO	NO	20	S5(40%)	F	IP41
GTN2-201P0	2000	1,0	≤ 150	Ø 485	6XØ12X18	32	1630	80	13,3	13,6	NO	NO	20	S5(40%)	F	IP41
GTN2-201P6	2000	1,6	≤ 150	Ø 485	6XØ12X18	50	1630	127	21,2	21,7	NO	NO	20	S5(40%)	F	IP41
GTN2-201P7	2000	1,75	≤ 150	Ø 485	6XØ12X18	53,8	1630	139	23,2	23,7	NO	NO	20	S5(40%)	F	IP41

**Remark:**

This machine can be configured with the manual wheel.

This machine can be configured with the remote manual brake release which is 4m.

Three brakes are applied to the condition of 2000kg rated load.



# GTN2

## Elevator Traction Machine

Voltage: 380V  
Suspension: 2:1  
Brake: DC110V 2/3\*0.93A  
Weight(with support): 1350kg  
Max. Static Load: 13000kg

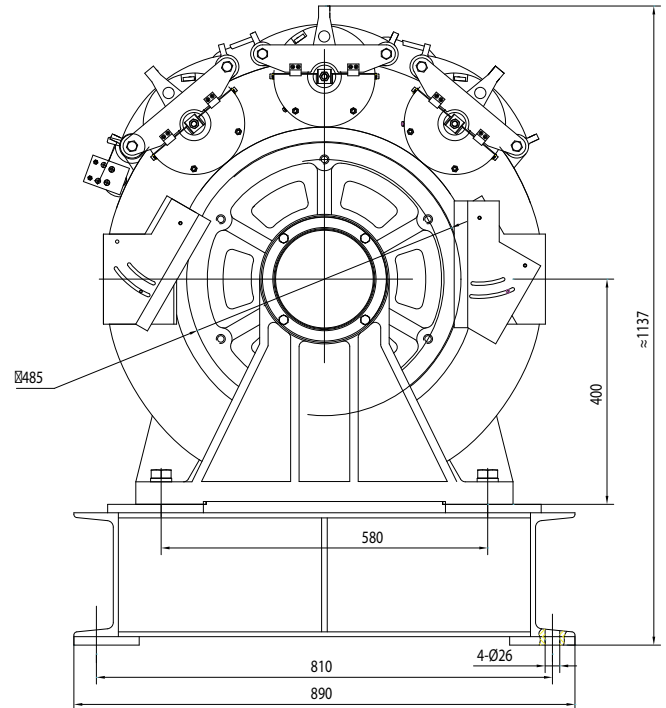
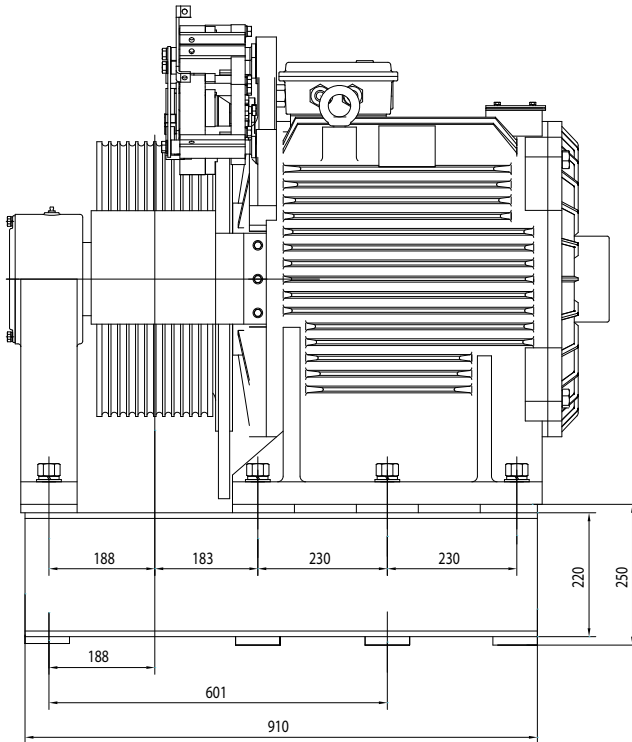

Spec	Load (kg)	Speed (m/s)	Height (m)	Sheave Ø (mm)	Rope sheave (mm)	Current (A)	Torque (Nm)	Rated speed (rpm)	Frequency (Hz)	Power (kW)	Double roping	Outside support	Pole	Rating	INS. class	IP code
GTN2-162P0	1600	2,0	≤ 150	Ø 485	10XØ12X16	49,8	1320	159	26,5	22	YES	YES	20	S5(40%)	F	IP41
GTN2-162P5	1600	2,5	≤ 150	Ø 485	10XØ12X16	60,8	1320	199	33,2	27,5	YES	YES	20	S5(40%)	F	IP41
GTN2-202P0	2000	2,0	≤ 150	Ø 485	12XØ12X16	61,8	1630	159	26,5	27,1	YES	YES	20	S5(40%)	F	IP41
GTN2-202P5	2000	2,5	≤ 150	Ø 485	12XØ12X16	74,5	1630	199	33,2	34	YES	YES	20	S5(40%)	F	IP41

**Remark:**

This machine can be configured with the manual wheel.

This machine can be configured with the remote manual brake release which is 4m.

Three brakes are applied to the condition of 2000kg rated load.

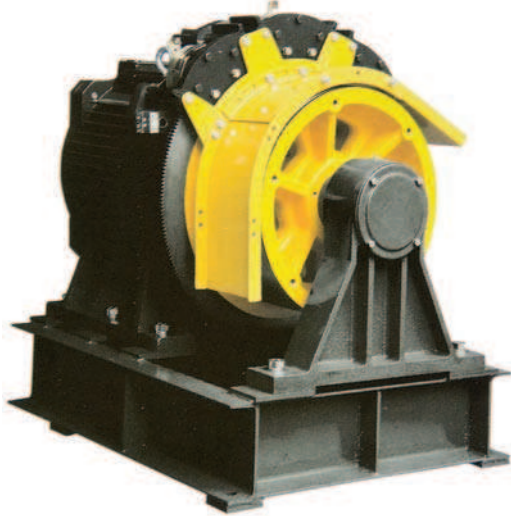

# GTN2

## Elevator Traction Machine

Voltage: 380V

Suspension: 2:1

Brake: DC110V 3\*0.93A

Weight(with support): 1400kg

Max. Static Load: 13000kg

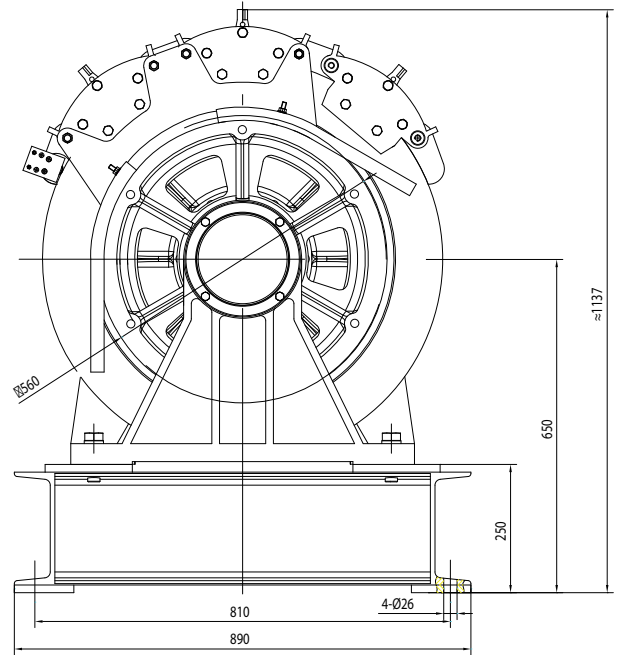
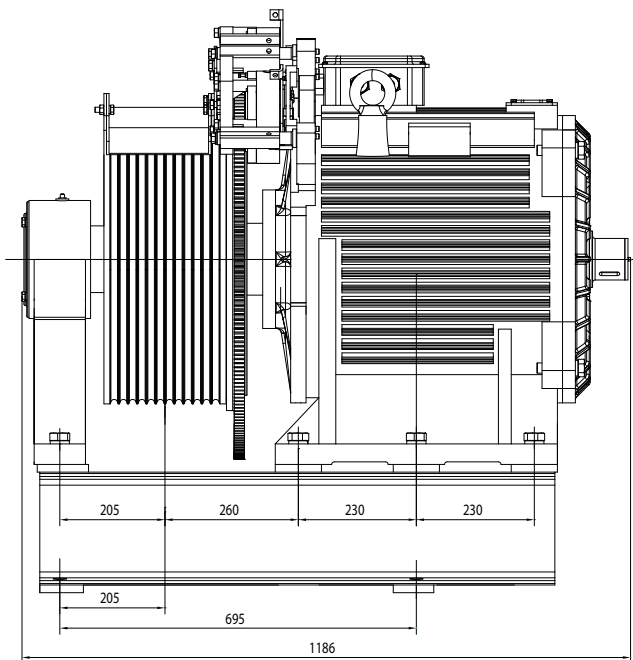

Spec	Load (kg)	Speed (m/s)	Height (m)	Sheave $\varnothing$ (mm)	Rope sheave (mm)	Current (A)	Torque (Nm)	Rated speed (rpm)	Frequency (Hz)	Power (kW)	Double roping	Outside support	Pole	Rating	INS. class	IP code
GTN2-163P0	1600	3,0	$\leq 150$	$\varnothing 560$	12X $\varnothing$ 13X18	75	1525	205	34,2	32,7	YES	YES	20	S5(40%)	F	IP41
GTN2-164P0	1600	4,0	$\leq 150$	$\varnothing 560$	12X $\varnothing$ 13X18	96	1525	273	45,5	43,6	YES	YES	20	S5(40%)	F	IP41
GTN2-203P0	2000	3,0	$\leq 150$	$\varnothing 560$	12X $\varnothing$ 13X18	94	1910	205	34,2	41	YES	YES	20	S5(40%)	F	IP41
GTN2-204P5	2000	4,0	$\leq 150$	$\varnothing 560$	12X $\varnothing$ 13X18	129	1910	273	45,5	54,3	YES	YES	20	S5(40%)	F	IP41